

Electro Magnetic LOCKS and accessories



CE FC RoHS COMPLIANT ISO 9001(2008)

ELECTROMAGNETIC LOCK SERIES



YM-60

Single Door Mini Magnetic Lock(120Lbs)

Size: 80Lx39Wx24.5H(mm)
 Holding Force: 60kg(120Lbs)
 Current Draw: 12V/120mA
 Suitable for:
 Cabinet
 Wooden Door
 Glass Door
 Fireproof Door
 Feature: Fail safe
 Weight: 0.6kg

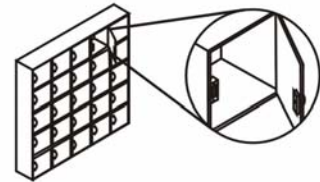

YM-70-S

Single Door Mini Magnetic Lock with Signal(140Lbs)

Size: 90Lx39Wx24.5H(mm)
 Holding Force: 70kg(140Lbs)
 Current Draw: 12V/240mA 24V/120mA
 Suitable for:
 Cabinet
 Wooden Door
 Glass Door
 Fireproof Door
 Feature: Fail safe
 Weight: 0.7kg

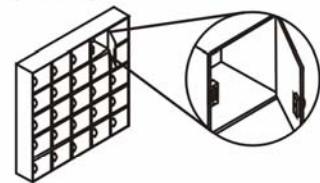

YM-180

Single Door Magnetic Lock(350Lbs)

Size: 170Lx41.4Wx20.5H(mm)
 Holding Force: 180kg(350Lbs)
 Current Draw: 300mA at 12VDC
 150mA at 24VDC
 Suitable for:
 Wooden Door
 Glass Door
 Metal Door
 Fireproof Door
 Feature: Fail Safe
 Weight: 1.2kg

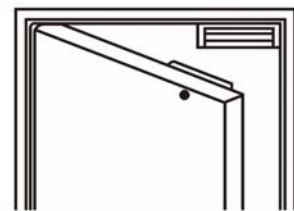

YM-180-S

Single Door Magnetic Lock with Signal(350Lbs)

Size: 183Lx41.4Wx20.5H(mm)
 Holding Force: 180kg(350Lbs)
 Current Draw: 300mA at 12VDC
 150mA at 24VDC
 Suitable for:
 Wooden Door
 Glass Door
 Metal Door
 Fireproof Door
 Feature: Fail Safe
 Weight: 1.2kg

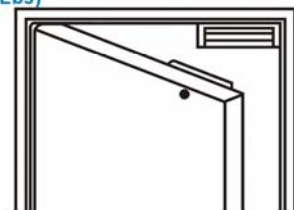

YM-180D

Double Door Magnetic Lock(350Lbsx2)

Size: 340Lx41.4Wx20.5H(mm)
 Holding Force: 180kgx2(350Lbsx2)
 Current Draw: 300mAx2 at 12VDC
 150mAx2 at 24VDC
 Suitable for:
 Wooden Door
 Glass Door
 Metal Door
 Fireproof Door
 Feature: Fail Safe
 Weight: 2.4kg

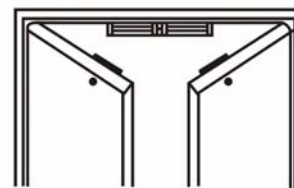

YM-180D-S

Double Door Magnetic Lock with Signal(350Lbsx2)

Size: 366Lx41.4Wx20.5H(mm)
 Holding Force: 180kgx2(350Lbsx2)
 Current Draw: 300mAx2 at 12VDC
 150mAx2 at 24VDC
 Suitable for:
 Wooden Door
 Glass Door
 Metal Door
 Fireproof Door
 Feature: Fail Safe
 Weight: 2.4kg

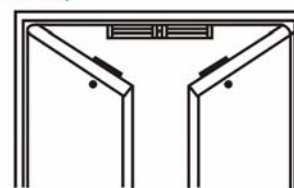

INSTALLATION OF MAGNETIC LOCK

Steps

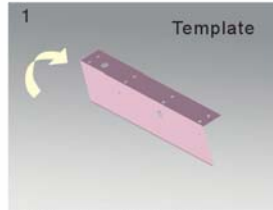
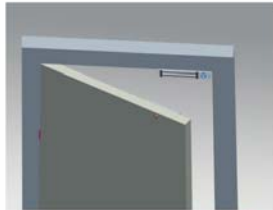

1 Fold the template to 90°

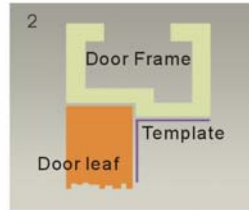

2 Close the door, place the template on door frame, close to door leaf.

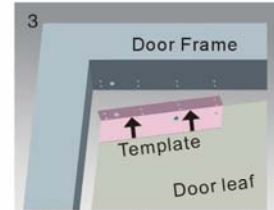

3 Mark screw positions on door leaf and door frame.



4 Drill holes on the marked positions

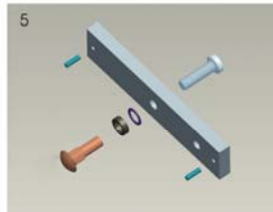

5 Install the Armature Plate on door leaf

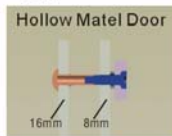

Hollow Metal Door
Drill a hole
Inside: Diameter is 8mm
Outside: Diameter is 16mm



Wooden Door
Drill a hole
Inside: Diameter is 8mm
Outside: Diameter is 12.7mm

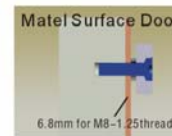

Metal Surface Door
Inside: Drill a hole
diameter is 8mm folding
the plastic straight pin

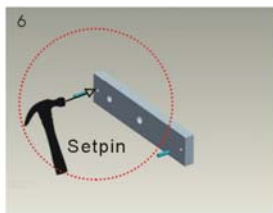

6 Put the pin into the Armature plate

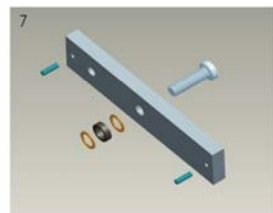

7 According to the picture add the washers on the Armature plate.

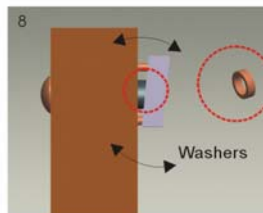

8 Place washers between Armature plate and door leaf



9 Use Allen Key to remove the Mounting plate from lock body

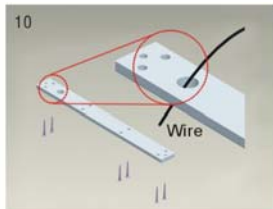

10 Wire go through the wire hole, then screw the mounting plate on top of the door frame.



11 Use Allen Key to screw the lock body on the mounting plate.

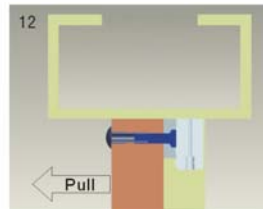

12 Close and pull the door to test holding force, extra washers can be added to adjust gap between door leaf and armature plate.

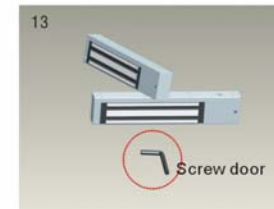

13 Confirm the holding force and tighten the proof screws

Optional Brackets

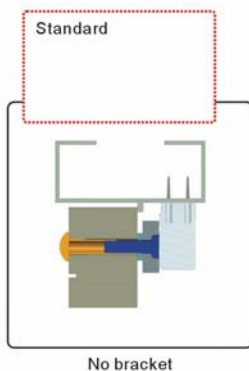

No bracket

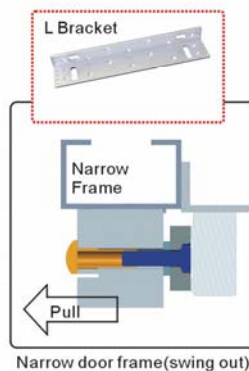

Narrow door frame (swing out)

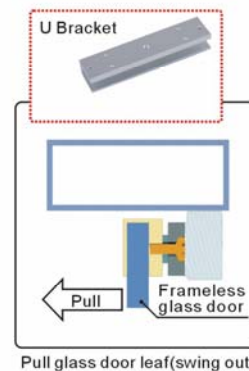

Pull glass door leaf (swing out)

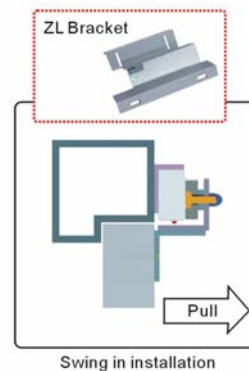

Swing in installation