

# Electric Strikes

# CATALOGUE

## and accessories

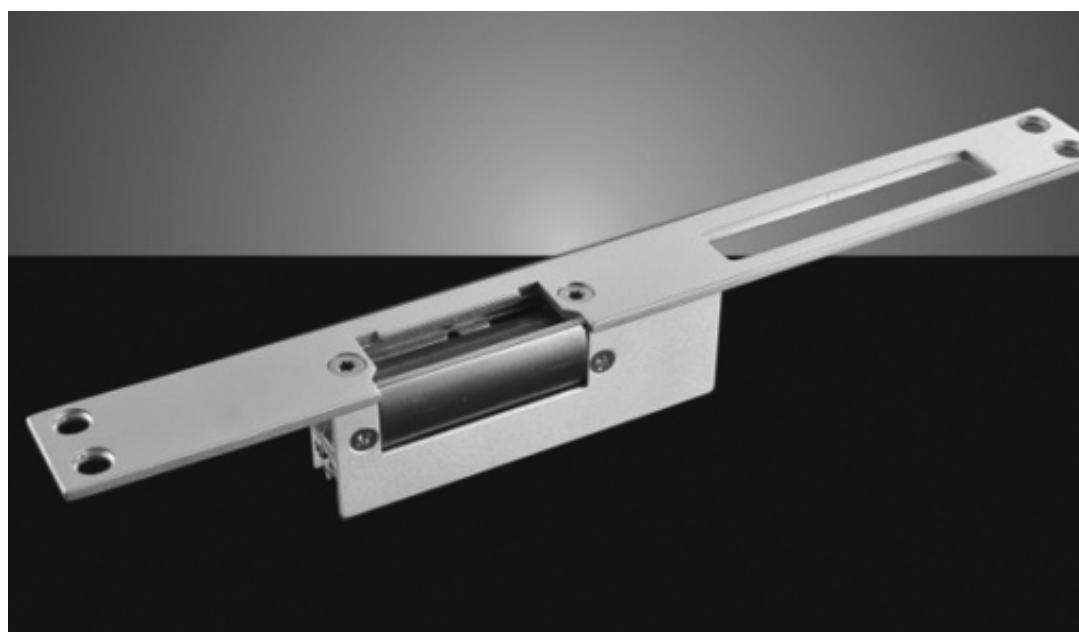

CE FC RoHS COMPLIANT ISO 9001(2008)

# ELECTRIC STRIKE SERIES



**Standard-type Electric Strike**

Size: 150Lx39.5Wx34H(mm)  
Voltage: 12V DC(24Vneed order)  
Current: 200mA  
Suitable For: Wooden Door, Metal Door  
Weight: 0.4kg

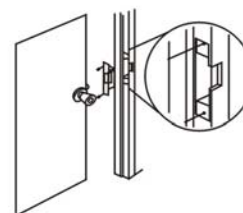

**Standard-type Electric Strike W/Signal**

Size: 150Lx39.5Wx34H(mm)  
Voltage: 12V DC(24Vneed order)  
Current: 200mA  
Suitable For: Wooden Door, Metal Door  
Signal output: Lock Signal NO/NC/COM  
Weight: 0.4kg

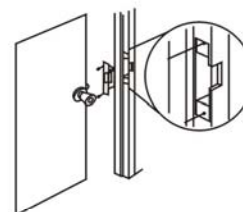

**Electric Strike with Short Faceplate**

Size: 160Lx25Wx31H(mm)  
Voltage: 12V DC(24Vneed order)  
Current: 200mA  
Suitable For: Wooden Door, Metal Door  
Weight: 0.4kg

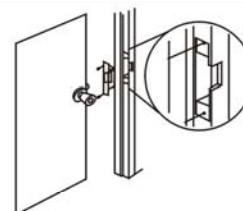

**Electric Strike with Short Faceplate W/Signal**

Size: 160Lx25Wx31H(mm)  
Voltage: 12V DC(24Vneed order)  
Current: 200mA  
Signal output: Lock Sensor NO/NC/COM  
Suitable For: Wooden Door, Metal Door  
Weight: 0.4kg

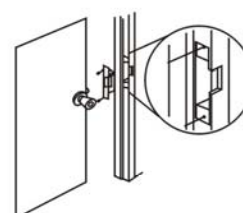

**Electric Strike with Long Faceplate**

Size: 250Lx25Wx31H(mm)  
Voltage: 12V DC(24Vneed order)  
Current: 200mA  
Suitable For: Wooden Door, Metal Door.  
Weight: 0.4kg

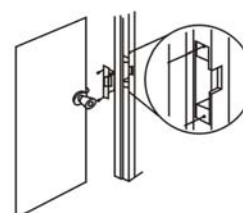

**Electric Strike with Long Faceplate W/Signal**

Size: 250Lx25Wx31H(mm)  
Voltage: 12V DC(24Vneed order)  
Current: 200mA  
Signal output: Lock Sensor NO/NC/COM  
Suitable For: Wooden Door, Metal Door.  
Weight: 0.4kg

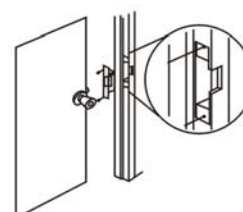

**Fail Safe Electric Strike for Glass Door**

Size: 160Lx25Wx31H(mm)  
Voltage: 12-24VDC(Adjustable)  
Current: 200mA  
Suitable for: Glass Door  
Glass Thickness: 12-15mm  
Fail safe : Locked when energized  
Weight: 0.4kg



# ELECTRIC STRIKE SERIES



### Fail Safe Electric Strike for Glass Door with Signal

Size: 160Lx25Wx31H(mm)  
Voltage: 12-24VDC(Adjustable)  
Current: 200mA  
Suitable for: Glass Door  
Glass Thickness: 12-15mm  
Signal Output: Lock Sensor NO/NC/COM  
Fail safe : Locked when energized  
Weight: 0.4kg



### European Type Adjustable Electric Strike with Short Faceplate

Size: 110Lx25Wx31.5H(mm)  
Voltage: 12V DC(24Vneed order)  
Current: 650mA  
Suitable For: Narrow Frame Wooden Door,  
Narrow Frame Metal Door.  
Face Plate : Stainless steel.  
Weight: 0.28kg

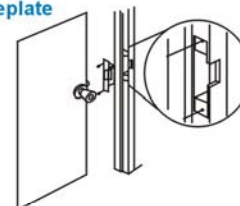

### European Type Adjustable Electric Strike with Long Faceplate

Size: 250Lx25Wx31.5H(mm)  
Voltage: 12V DC(24Vneed order)  
Current: 650mA  
Suitable For: Narrow Wooden Door,  
Narrow Metal Door.  
Face Plate : Stainless steel.  
Weight: 0.35kg

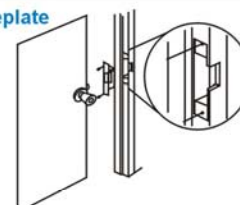

### ANSI Standard Heavy Duty Electric Strike

Size: 124Lx43Wx42H(mm)  
Voltage: 12V DC(24Vneed order)  
Current: 320mA  
Suitable For: Wooden Door, Metal Door.  
Face Plate : Stainless steel.  
Weight: 0.34kg

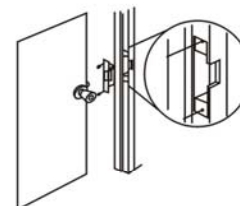

### ANSI Standard Heavy Duty Electric Strike W/Signal

Size: 124Lx43Wx42H(mm)  
Voltage: 12V DC(24Vneed order)  
Current: 320mA  
Suitable For: Wooden Door, Metal Door.  
Face Plate : Stainless steel.  
Signal output: Lock Sensor NO/NC/COM  
Weight: 0.34kg

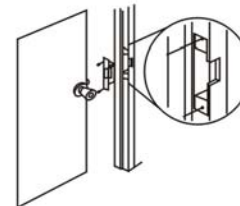

### European Standard Heavy Duty Electric Strike

Size: 174Lx44Wx27H(mm)  
Voltage: 12V DC(24Vneed order)  
Current: 12V/220mA;24V/110mA  
Suitable For: Wooden Door, Metal Door.  
Face Plate : 304 Stainless steel  
Panel selection: Stainless steel, high strength aluminum alloy  
Signal output: Lock Sensor & Door Sensor( NO/NC/COM)  
Weight: 0.5kg

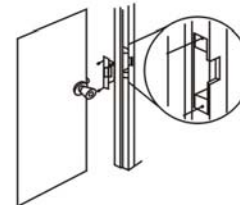

### Electric Strike for Push Bar

Size: 230Lx40Wx30H(mm)  
Lock tongue structure: 304 Stainless Steel  
Current: 12V/220mA or 24V/110mA  
Signal Output: Lock Sensor & Door Sensor( NO/NC/COM)  
Special design: Applies to all brands of fire push rod lock  
Suitable For: Supporting rod lock fire door  
Face plate Housing: High temperature paint  
Lock tongue: Surface by coating nickel  
Weight: 0.75kg

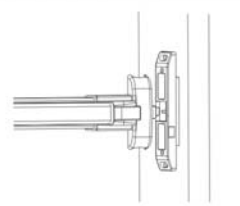

# ELECTRIC STRIKE SERIES



**YS-622-S**

**Electric Strike for Push Bar**

Size: 153.5Lx43Wx49H(mm)  
 Bolt Material: Harden 304 Stainless Steel  
 Current: 12V/220mA  
 Signal Output: Door Sensor( NO/NC/COM)  
 Feature: Fail Safe / Fail Secure adjustable  
 Special design: Applies to all brands of fire push rod lock  
 Suitable For: European & American fire push bar  
 Face plate Housing: High temperature paint  
 Weight: 0.52kg



**YS-138**

**ANSI Standard Heavy Duty Electric Strike**

Size: 124Lx32Wx33H(mm)  
 Voltage: 12V DC(24Vneed order)  
 Current: 220mA  
 Feature: Fail Safe / Fail Secure adjustable  
 Suitable For: Wooden Door, Metal Door.  
 Face Plate : Stainless steel.  
 Weight: 0.38kg

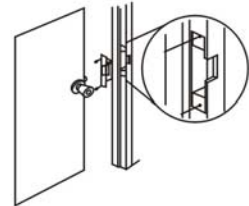

**YS-138-S**

**ANSI Standard Heavy Duty Electric Strike W/Signal**

Size: 124Lx32Wx33H(mm)  
 Voltage: 12V DC(24Vneed order)  
 Current: 220mA  
 Suitable For: Wooden Door, Metal Door.  
 Face Plate : Stainless steel  
 Feature: Fail Safe / Fail Secure adjustable  
 Signal output: Lock Sensor NO/NC/COM  
 Weight: 0.38kg

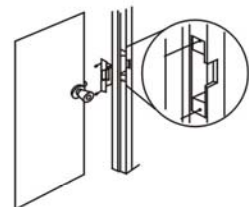

**YS-138L**

**ANSI Standard Heavy Duty Electric Strike with Long Faceplate**

Size: 165LX32WX33H(mm)  
 Voltage: 12V DC(24Vneed order)  
 Current: 220mA  
 Feature: Fail Safe / Fail Secure adjustable  
 Suitable for: Wooden door , Metal door  
 Face Plate: Stainless steel  
 Weight: 0.4kg

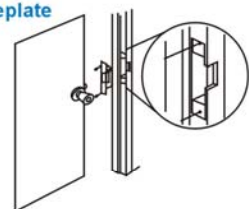

**YS-138L-S**

**ANSI Standard Heavy Duty Electric Strike with Long Faceplate & Signal**

Size: 165LX32WX33H(mm)  
 Voltage: 12V DC(24Vneed order)  
 Current: 220mA  
 Suitable for: Wooden door , Metal door  
 Signal output: Lock Sensor NO/NC/COM  
 Feature: Fail Safe / Fail Secure adjustable  
 Face Plate: Stainless steel  
 Weight: 0.4kg

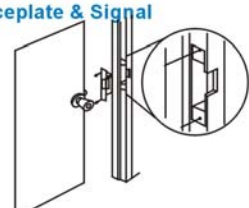

**YS-138LK**

**European Type Heavy Duty Electric Strike**

Size: 250LX32WX33H(mm)  
 Voltage: 12V DC(24Vneed order)  
 Current draw: 220mA  
 Feature: Fail Safe / Fail Secure adjustable  
 Suitable for: Wooden door , Metal door  
 Face Plate: Stainless steel  
 Weight: 0.42kg

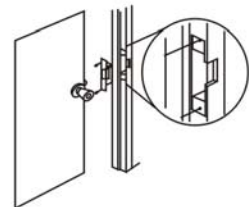

**YS-138LK-S**

**European Type Heavy Duty Electric Strike with Signal**

Size: 250LX32WX33H(mm)  
 Voltage: 12V DC(24Vneed order)  
 Current: 220mA  
 Suitable for: Wooden door , Metal door  
 Signal output: Lock Sensor NO/NC/COM  
 Feature: Fail Safe / Fail Secure adjustable  
 Face Plate: Stainless steel  
 Weight: 0.42kg

