

# Electric DROP BOLT locks and accessories



CE FC RoHS COMPLIANT ISO(2008)

# ELECTRIC DROP BOLT SERIES



**YB-100S**

**Fail Safe Electric Bolt W / Magnetic Feature**

Size: 205Lx35Wx40H(mm)  
Voltage: 12V DC  
Current: Start 900mA , Standby 120mA  
Suitable for: Wooden Door, Glass Door,  
Metal Door, FireProof Door  
Feature: Fail Safe  
Weight: 0.72kg

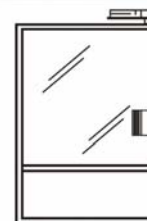

**YB-100**

**Fail Safe Electric Bolt W / Signal**

Size: 205Lx35Wx40H(mm)  
Voltage: 12V DC  
Current: Start 900mA , Standby 110mA  
Suitable for: Wooden Door, Glass Door,  
Metal Door, FireProof Door  
Feature: Fail Safe  
Weight: 0.72kg



**YB-100+**

**Fail Safe Electric Bolt W / Signal & Time**

Size: 205Lx35Wx40H(mm)  
Voltage: 12V DC  
Current: Start 900mA , Standby 110mA  
Suitable for: Wooden Door, Glass Door,  
Metal Door, FireProof Door  
Feature: Fail Safe  
Time Delay: 0,3,6,9sec  
Weight: 0.72kg



**YB-100+LED**

**Fail Safe Electric Bolt W / Signal,Time &LED**

Size: 205Lx35Wx40H(mm)  
Voltage: 12V DC  
Current: Start 900mA , Standby 110mA  
Suitable for: Wooden Door, Glass Door,  
Metal Door, FireProof Door  
Feature: Fail Safe  
Time Delay: 0,3,6,9sec  
Weight: 0.72kg



**YB-200**

**Fail Safe Electric Bolt W / Signal,Time &LED**

Size: 205Lx35Wx40H(mm)  
Voltage: 12V DC  
Current: Start 900mA , Standby 110mA  
Suitable for: Wooden Door, Glass Door,  
Metal Door, Fireproof Door  
Feature: Fail Safe  
Time Delay : 0,3,6,9sec  
Weight: 0.72kg

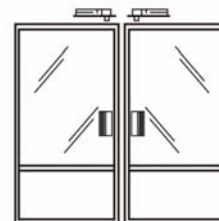

**YB-300**

**Fail Safe Electric Bolt W/signal, Time, Open Wire (12-24v)**

Size: 205Lx35Wx40H(mm)  
Voltage: 12V-24V  
Current: Start 900mA , Standby 100mA  
Suitable For: Wooden Door, Glass Door,  
Metal Door, FireProof Door  
Feature: Fail Safe  
Time Delay: 0,3,6,9sec  
Weight: 0.74kg

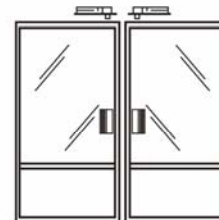

**YB-400**

**Fail Safe Electric Bolt For Auto-door**

Size: 205Lx35Wx40H(mm)  
Voltage: 12V DC  
Current: Start 930mA , Standby 130mA  
Suitable For: Auto- door  
Feature: Fail Safe  
Time Delay: 0, 3, 6, 9sec  
Weight: 0.72kg

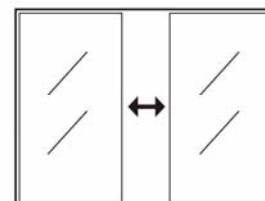

# ELECTRIC DROP BOLT SERIES



**YB-500A(LED)**

**Fail Safe Sturdiness Electric Bolt W/narrow Panel**

Size: 192Lx25Wx37H(mm)  
Voltage: 12V DC  
Current: Start900mA  
Stand by : 80mA  
Suitable for: Wooden Door, Glass Door,  
Metal Door, Fireproof Door  
Feature: Fail Safe  
Induction Distance: 8mm  
Time Delay: 0,3,6,9sec  
Weight: 0.68kg

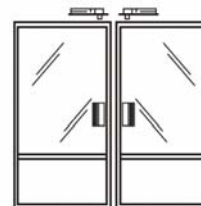

**YB-500B(LED)**

**Fail Secure Sturdiness Electric Bolt W/narrow Panel**

Size: 192Lx25Wx37H(mm)  
Voltage: 12V DC Low Power  
Current: Start900mA  
Stand by: 80mA  
Suitable for: Wooden Door, Glass Door,  
Metal Door, Fireproof Door  
Feature: Fail Secure  
Induction Distance: 8mm  
Time Delay: 0,3,6,9sec  
Weight: 0.68kg



**YB-500C(LED)**

**Fail Secure Sturdiness Electric Bolt with Cylinder**

Size: 210Lx25Wx42H(mm)  
Bolt: 16mmDIA, stainless steel 13mm throw  
Voltage: 12V DC(24V DC need order)  
Current: Start960mA  
Stand by: 130mA  
Suitable For: Wooden Door, Glass Door,  
Metal Door, Fireproof Door  
Feature: Fail Secure  
Signal Output: Door status Output, NC/COM  
Time Delay: 0,3,6,9sec  
Weight: 1.0kg



**YB-500U**

**Fail Safe Electric Bolt for Fully Frameless Glass Door**

Safe: 150Lx40Wx38H(mm)  
Voltage: 12V DC(24V DC)  
Current: Start800mA  
Standby : 120mA  
Signal Output: Door status Output, NO/COM  
Suitable For: 10-12mm Frameless Glass Door  
Feature: Fail Safe  
Time Delay: 0,3,6,9sec  
Weight: 1.36kg

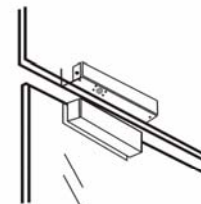

**YB-500I**

**Fail Safe Sturdiness Electric Bolt For Narrow Frame Door**

Size: 150Lx24Wx36H(mm)  
Voltage: 12V DC(24V DC)  
Current: Start900mA  
Standby : 120mA  
Feature: Fail Safe  
Time Delay: 0,3,6,9sec  
Weight: 1.06kg

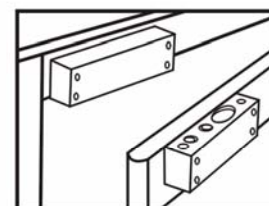

**YB-600A**

**Fail Safe Electric Bolt W/signal, Time, Open Wire, & Cylinder**

Size: 260Lx30Wx48H(mm)  
Voltage: 12V DC  
Current: Start 1000mA, Standby 90mA  
Suitable For: Heavy Door, Metal Door, Wooden Door  
Signal Output: Door status Output, NO/NC/COM  
Feature: Fail Safe  
Time Delay: 0,3,6,9sec  
Weight: 1.6kg

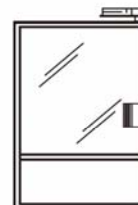

**YB-600B**

**Fail Secure Electric Bolt W/signal, Time, Open Wire, & Cylinder**

Size: 260Lx30Wx48H(mm)  
Voltage: 12V DC  
Current: Start 1000mA, Standby 90mA  
Suitable For: Heavy Door, Metal Door, Wooden Door  
Signal Output: Door status Output, NO/NC/COM  
Feature: Fail Secure  
Time Delay: 0,3,6,9sec  
Weight: 1.6kg





# BRACKET & INSTALLATION OF ELECTRIC BOLT



### Aluminium Bracket for Narrow Frame Door

Use with: YB-100/100+/100+LED/100S/300  
(YB-200/700 need order)  
Suitable for : Inswing Door  
Opening Mode: 90 or 180 Degree Door  
Finishing: Anodized aluminum  
Weight: 0.6kg

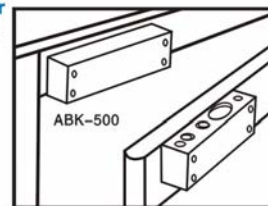

### Stainless Steel Bracket for Frameless Glass Door

Used with: YB-100/100+/100+LED/100/  
YB-100S/ YB-200/300  
Glass Thickness: 10-15mm  
Suitable for : Glass door  
Opening Mode: 180 degree swing door  
Weight: 0.3kg



### Bracket Specially for Frameless Glass Door (aluminium)

Used with: YB-100/100+/100+LED/100S/  
YB-200/300  
Glass Thickness: 10-12mm  
Suitable for : Glass door  
Opening Mode: 180 degree swing door  
Weight: 0.27kg

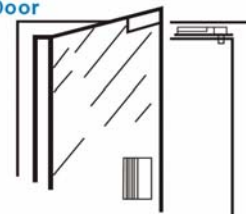

### Stainless Steel Bracket for Fully Frameless Glass Door

Size: 205Lx58Wx46H(mm)  
Glass Thickness: 10-15mm  
Suitable for: Glass door  
Opening Mode: 180 degree swing door  
Used with: YB-100/100+/100+LED/100S/200  
YB-300(YB-700 need special order)  
Weight: 1.6kg



## Installation of electric drop bolt

	A	B	C	D	E
YB-100/YB-100+	207	36	12	91	26
YB-100S	207	36	12	91	26
YB-100+LED	207	36	12	91	26
YB-200	207	36	12	91	26
YB-300	207	36	12	91	26
YB-500A/B	194	27	12	91	26
YB-700A/B	207	31	12	101	26

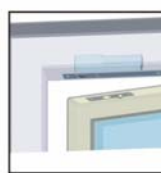
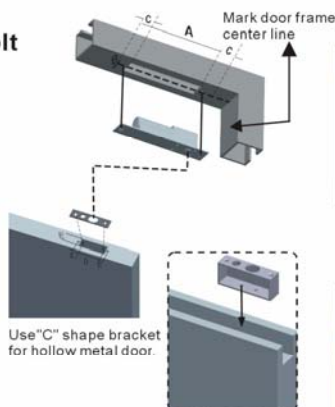

Standard Installation  
B1

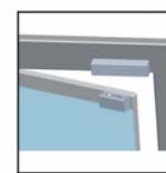

ABK-500  
B2



ABK-600/601/602  
B3

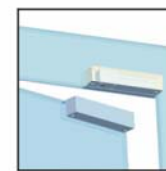

ABK-700  
B4

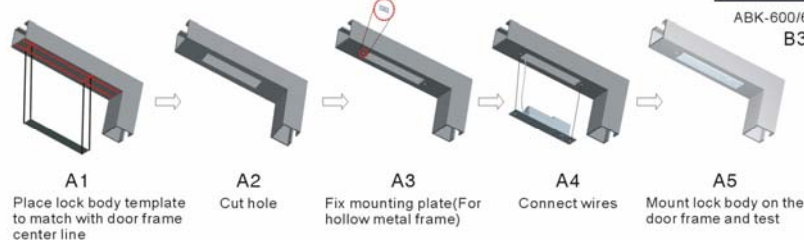

**Note : All the electric drop bolt brackets will be changed from ABK to BBK**